

GETTING TO

Women's Imaging

Medical Arts Pavilion (MAP), 1st. floor, Suite 180

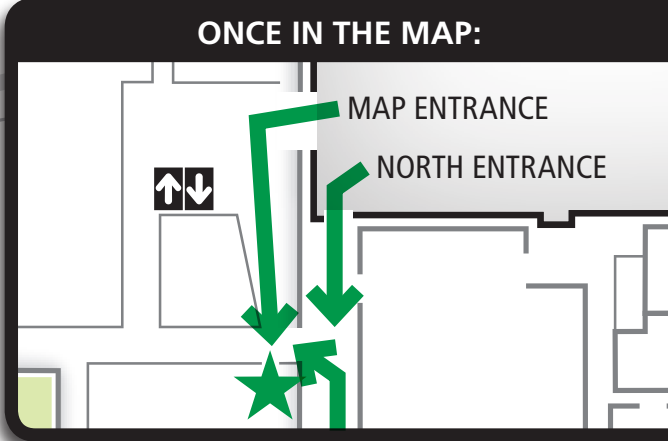
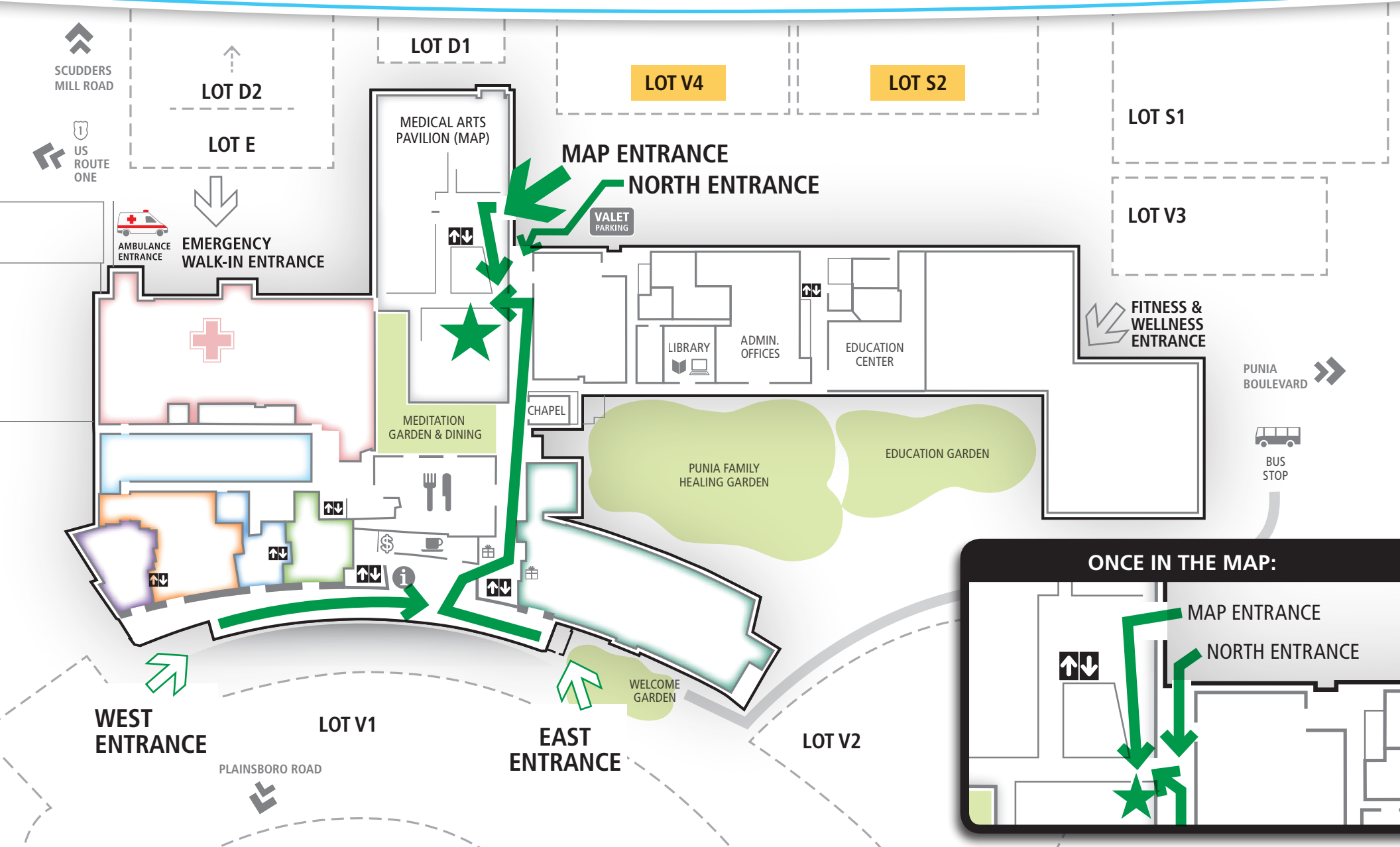

GETTING TO

Women's Imaging

Medical Arts Pavilion (MAP), 1st. floor, Suite 180

609.853.6700

CLOSEST PARKING LOT:

V4 or S2, entrance via Campus Road, Hospital Drive

- **Closest free self-parking** is available **behind the rear of the hospital** (the curved, silver building). Follow the signs for Emergency and then look for the signs for **Medical Arts Pavilion (MAP)** parking. This will be **Parking Lot V4**.
- **Valet parking** is available for a minimal charge on weekdays **between 7:00 a.m. and 5:00 p.m. (See website for current pricing and additional information.)** It is **accessible at the North Entrance** of the hospital, which is next to the Medical Arts Pavilion entrance. The valet will drop you off at any entrance you choose. To reach the valet service, please call (609) 853-6963.
- **Handicapped parking** spaces are available. If you are unable to find a handicapped space, please use the valet parking service free of charge. To reach the valet service call (609) 853-6963.
- **Please avoid parking in lots E or D2**, as these are closest to Emergency Walk-in Entrance.

CLOSEST ENTRANCE:

Medical Arts Pavilion (MAP) Entrance

From Parking Lot V4:

- Enter the **Medical Arts Pavilion, which is located to your right when you are facing the back side of the hospital** (silver building) or the Education building (brick building).

- **Enter** through the brown (bronze) double doors.
- Turn immediately to your left, and continue down the hall to the glass door.
- This is the entrance to the **Women's Imaging/ Maternal Fetal Medicine, Suite 180**. Enter through this door and there will be a Patient Access staff member to greet you.

If you parked in lots V1 or V2, at the front of the hospital:

- Use either the **West or East Entrances** and walk into the hospital **Main Lobby**.
- As you stand in the center of the **Main Lobby**, with the large glass windows behind you, the **Information/Concierge desk** will be to the **left**, and the **Gift Shop** will be in front of you to your **right**.
- Proceed toward the **Gift Shop** and turn **left** when you reach it.
- Continue straight past the **Restaurant** on your **left** and the **Chapel of Light** on your **right**.
- Continue straight and make a **left** into the **Medical Arts Pavilion (MAP)** building, Maternal Fetal Medicine, Suite 180, will be immediately on your left.

ONCE IN WOMEN'S IMAGING:

A Patient Access Associate will greet you. Please have your prescription for the procedure available, along with any paperwork you were advised to bring.